

ADJUSTABLE PROFILES: P02C

CHARACTERISTICS

180° Adjustable profile with wall-washer function for surface installation.

CAN BE USED WITH LED STRIPS WITH MAXIMUM WIDTH:

14 mm.

MAXIMUM POWER:

30W/m

MATERIALS

6063 aluminium profile with white PMMA screen.

ACCESSORIES INCLUDED

Every 3 metre bar is complete with 3 end caps (with and without hole) and 3 sets of adjustable brackets.

INSTALLATION

Surface installation with the special brackets. Cabling can be in line with the profile or exit the bottom of the profile.

PACKAGE

Supplied in packages of 5 bars, each one measuring 3 meters complete with screen and accessories. Spare accessories available with separate code.

Cutting Project profiles to size*:

fixed cost of piece work

VA04

* Includes mounting accessories.

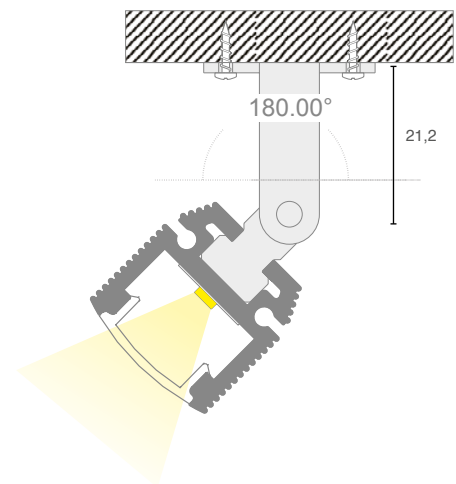
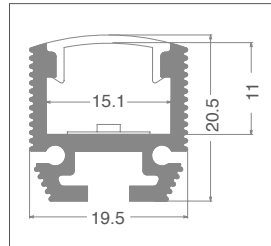

IP20

art	Description	L1	H	L	8011905	
P02C-S-PF-300 ♦	profile complete with screen and accessories	19,5	20,5	3000	912611	1 / 5



♦ To be discontinued



art	Description	8011905	
P02C-A-EC ♦	3+3 metal end caps	912628	1



art	Description	8011905	
P02C-A-OB ♦	3 Pairs of metal adjustable brackets	912635	1

♦ To be discontinued